

Catalog # :

Project :

Prepared By :

Date :



IHB4 LED 4FT Industrial LED

With quick paybacks and efficiencies of up to 152 lumens per watt, the Industrial High Bay series is the best value high bay when upgrading from metal halide or fluorescent fixtures. Available in 5 lumen packages that produce a brighter and whiter light output and a smoother light pattern.

Features & Specifications

Optical System

- The optional high transmission lens, with 91% efficiency, is high impact, scratch resistant and protects the LEDs.
- Delivers improved visual comfort by eliminating any glare and providing a wider smoother and more uniform light output.
- LSI LEDs provide higher lumen output and greater energy efficiency
- Minimum CRI of 82.0

Electrical

- Standard Universal Voltage (120-277 Vac) Input 50/60 Hz or optional High Voltage (347-480 Vac).
- L70 Calculated Life: 200,000+ Hours
- Driver is constant current, Class 2, 120-277 Vac, 50-60 Hz
- High Efficiency Driver: minimum 85%
- Driver Off-State Power is 0 Watts
- 0-10V dimming (1% - 100%) standard.
- Optional 120v-277v integral emergency battery pack is available to meet critical life safety lighting requirements. The 90-minute batteries provide constant power to the LED system, ensuring code compliance. A test switch/indicator button is installed on the housing for ease of maintenance.
- Emergency Backup Driver has 5W Input, 12W output.

Construction

- Rigid housing is die-formed thick gauge steel and aluminum.
- All metal parts are painted after fabrication following treatment with phosphate rust inhibitor. Finish coating of housing reflecting surfaces is with high-reflectance white (minimum 92%) polyester powder.
- The lightweight heat sinks are designed to perform in ambient temperatures up to 50°C.
- The Quick Wire access panel allows for easy power connection.
- LEDs manufactured for the IHB4 series utilize Epoxy Guard conformal coating which reduces the chance of board corrosion.
- Luminaire is proudly assembled in the U.S.
- Weight: 17.4 lbs



Dimensions

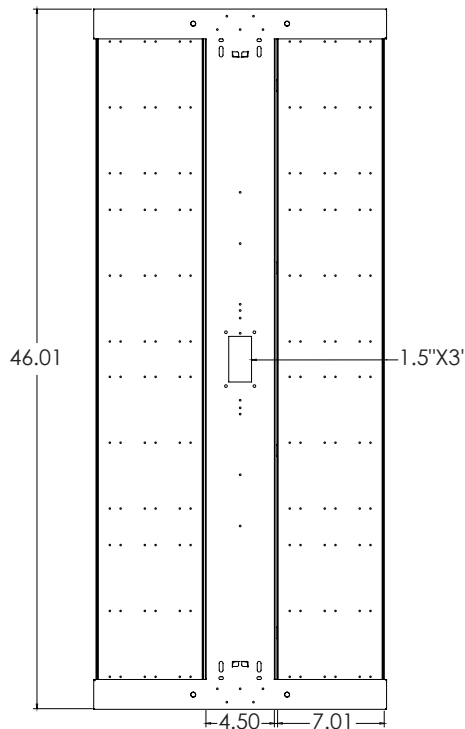
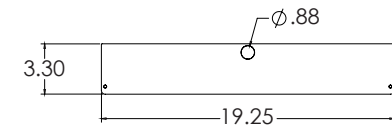



IHB4 LED 4FT Industrial LED

Features & Specifications (Cont.)

Control

- Optional integral passive infrared motion sensors and daylight sensors activate switching of luminaire light levels (see page 3 for more details).

Installation

- Suitable for suspension by chain, cable, or single (pendant) mono-point. To maintain ambient listing, mount minimum 6" from ceiling.

Warranty

- LSI LED Fixtures carry a 5-year warranty.
- 1 Year warranty on optional Battery Back Up. Test regularly in accordance with local codes

Listings

- LSI LED luminaires have been tested by an independent laboratory in accordance with IESNA LM-79 & LM-80.
- Listed to UL 1598 and UL 8750.
- RoHS Compliant.
- State of California Title 24.
- American Recovery and Reinvestment Act Funding Compliant.
- Suitable For Damp Locations.
- DesignLights Consortium Premium qualified luminaire, eligible for rebates from DLC member utilities.

DLC Listings

IHB4		
	4000K	5000K
Lumens	DLC Prod. ID	DLC Prod. ID
24L	PZ5K12HT	PX6P3VTL
30L	PNT40CGM	PAHKY4LQ
36L	POFW27IU	PS2L2DB8
48L	P8F86TTV	PZ0J6XCC

Performance

IHB4						
	4000K			5000K		
Lumens	Delivered Lumens	Efficacy	Wattage	Delivered Lumens	Efficacy	Wattage
24L	25020	152.04	164.56	25020	152.04	164.56
30L	30390	149.06	203.88	30390	149.06	203.88
36L	37540	150.59	249.29	37540	150.59	249.29
48L	44450	146.45	303.52	44450	146.45	303.52

IHB4 W/ DA LENS						
	4000K			5000K		
Lumens	Delivered Lumens	Efficacy	Wattage	Delivered Lumens	Efficacy	Wattage
24L	23620	143.81	164.25	23620	143.81	164.25
30L	28600	140.60	203.41	28600	140.60	203.41
36L	35120	141.19	248.75	35120	141.19	248.75
48L	40760	134.57	302.90	40760	134.57	302.90

IHB4 W/ DA LENS		
	4000K	5000K
Lumens	DLC Prod. ID	DLC Prod. ID
24L	PX521A3Y	PZTESFUU
30L	PNVR2M8L	PMW36T3Z
36L	P90IR779	PGGR2XFV
48L	P0BLJLLZ	P8SCHM69

DesignLights Consortium Premium qualified luminaires, eligible for rebates from DLC member utilities.

Luminaire Ordering Guide

TYPICAL ORDER EXAMPLE: **IHB4 LED 48L LL UNV DIM 40**

Family Prefix	Light Source	Lumen Package	Diffuser / Distribution	Voltage	Driver	Color Temp	Options / Controls
IHB4 = 4' Industrial High Bay	LED	24L - 24000 30L - 30000 36L - 36000 48L - 48000	LL = Less Lens DA = Diffused	UNV = Universal (120V-277V) HV = 347-480V Universal Voltage	DIM = Dim to 10% (0 to 10V)	40 = 4000K 50 = 5000K	'xC - x' Cord (No Plug) 'xT - x' 120V Cord & Plug 'xE - x' 208V Cord & Plug 'xF - x' 240V Cord & Plug 'xS - x' 277V Cord & Plug EM = Emergency Battery OC = Occupancy Sensor IMS - Integrated Motion Sensor WG - Wireguard

1 - x = 3', 6' and 10' lengths



Integrated Control Specifications



Features

- Omni-directional quad element infrared sensor
- 100~277VAC universal line voltage powered
- Frequency detection zero-cross relay switching
- 0-10V selectable output for low dim control
- Walk test and sensor operation LED indicator
- Direct lead wires for easy wiring connections
- 8 rotary DIP switch selectable control modes

Specifications

Power Supply	120/277VAC, 50/60Hz
Maximum Load	800W
Infrared Sensor	Omni-Directional Quad Element Pyroelectric
Detectable Speed	0.5~10 ft./second (0.15~3m/second)
Mounting Height	Subject to the lens type applied
Detection Range	Subject to the lens applied and height
Zero Crossing	Automatic frequency detection
Low Dim Control	0-10V
Dim Output Current	Max. 2mA @ 120VAC Max. 5mA @ 277VAC
Low Dim Level	0/5/10/20/25/33/50% selectable
Ambient Light Level	L: 20~50 lux, M: 80~130 lux, H: 500~600 lux
Delay Time Setting	1'3'/5'/10'/15'/20'/30' selectable
Time-Off Delay	10 min., TO modes only
Op. Humidity	Max. 95% RH
Op. Temperature	-40°F~131°F (-40°C~55°C)
Dimensions	Ø2.36" x 1.45"H (Ø60 x 37mm)

*10 lux equals to approximately 1 ft. candle

Wiring Diagram

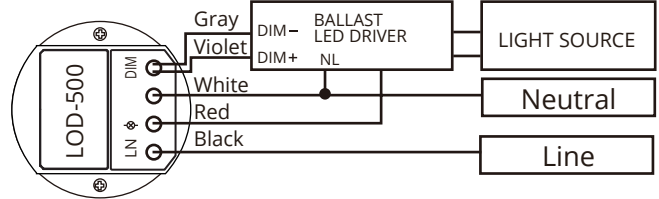



Occupancy Sensor Specifications



Electrical

- Input Voltage: 120/227/347VAC
- Operational Frequencies: 50/60Hz
- Wire Designation: Line - Black, Load - Red, Neutral - White
- Load Rating:
800VA@120VAC
1200VA@277VAC
1500VA@347VAC
- Mounted: 1/4 HP Motor Load @ 120V

Environmental

- Operating Temperature Range: 14°F to 160°F

Construction

- High Impact Housing
- Injection Molded Plastic
- Color Coded Wire Leads are 42" Long

Specifications

- Size: 3.5"W x 3.5"H x 1.25"D (8.89cm x 8.89cm x 3.175cm)
- Color: White
- UL and cUL certified, Photoelectric Switch, CEC Title 24 Compliant

Controls

Timer Setting: 30 seconds - 20 minutes

Range & Coverage

The 360° PIR lens provides a 2:1 spacing to mounting height coverage under 25 ft. mounting and a 1.5:1 for heights up to 40 ft. mounting. The aisle lens is designed to provide detection of 60 ft. long by 20 ft. wide for heights up to 40 ft. mounting.

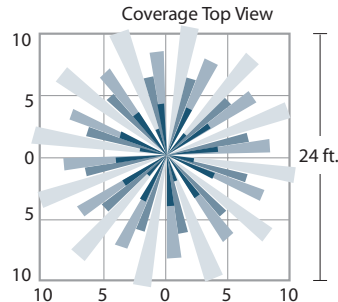

MS360 High Bay Lens

Typical Mounting Height: 20-40'
Optimal Coverage
24' diameter at 20' height;
increased coverage density
Application
high bay, open area

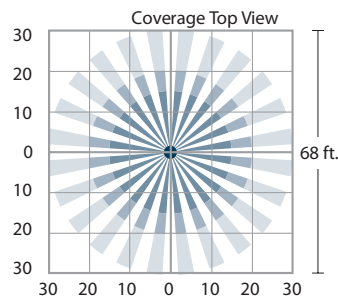

MS360 Low Bay Lens

Typical Mounting Height: 8-20'
Optimal Coverage
40' diameter at 20' height;
increased coverage density
Application
low bay, open area

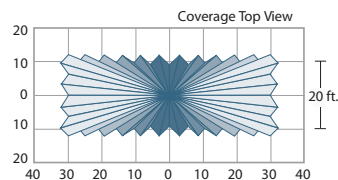

MS360 Aisle Lens

Typical Mounting Height: 20-40'
Optimal Coverage
60' linear x 20' width
Application
high bay, aisle ways

