



THE GREENBRIAR[®] WALL SCONCE SERIES

*Small and Medium
Available in HID and
Compact Fluorescent*



THE GREENBRIAR® WALL SCONCE SERIES – DESIGNED TO COMPLEMENT THE AESTHETICS OF SQUARE AND RECTANGULAR SITE LIGHTING FIXTURES

Indoor or outdoor, uplight or downlight, wall mount or pole mount, the Greenbriar Wall Sconce Series establishes a new benchmark for decorative wall sconce fixtures.

The Greenbriar Wall Sconce Series is available in two housing sizes, in high-performance HID and energy-efficient single and multiple Compact Fluorescent lamp sources, and an assortment of finishes and color decals.

For those who place a premium on architectural design continuity, these smartly designed, highly versatile fixtures can tie together your entire site – accommodating your area, wall and pedestrian lighting needs.

MEETS IESNA
FULL CUTOFF
CLASSIFICATION



Downlight mounting is available for indoor and outdoor applications.



Uplight mounting is available for indoor or under canopy applications.



Pole-mounting is available for pedestrian scale lighting applications.



COMPACT FLUORESCENT LAMPS (CFL) THAT ENTER THE REALM OF HID

The Greenbriar Wall Sconce offers a multiple 26, 32, 42, 57, and 70-watt Compact Fluorescent light source, which is an attractive alternative to traditional Metal Halide lamps. These lamps provide an energy-efficient, high color rendition light source with multiple lamp-switching flexibility.



- *Up to 26% more energy efficient than a horizontal Metal Halide lamp (based on lumens per watt calculated using mean lumens)*
- *High color rendering index (CRI) of 82*
- *Amalgam Technology for excellent lamp-to-lamp consistency*
- *Flicker-free, instant start light source with quicker ramp-up to full output*
- *CFL available with optional dimming ballast for multiple types of controls, such as building lighting controls and occupancy sensors*

ARCHITECTURAL HOUSING

Formed aluminum housing is rectangular in shape, featuring sleek, smooth lines. All mounting hardware is stainless steel or electro-zinc plated steel.

TWO SIZES

Small size is available from 50 to 150 Watts HID and 26 to 2/42 Watts Compact Fluorescent. Medium fixture is available from 250 to 400 Watts HID and 26 to 2/70 Watts Compact Fluorescent.

	A	B	C	D
Small	17-5/8"	9-5/8"	10-1/8"	5-3/8"
Medium	20"	13-7/16"	11-5/32"	8-5/8"

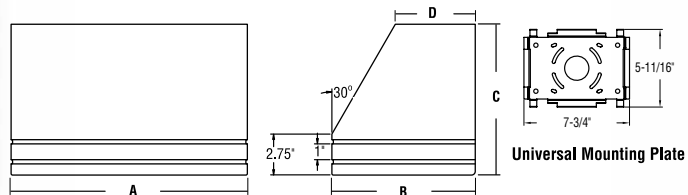

FINISH COLORS & ACCENT STRIPING

Each Greenbriar fixture is finished with DuraGrip®, LSI's baked-on, polyester-powder coat finishing process. LSI's DuraGrip finish withstands weather changes without cracking or peeling, and is guaranteed for 5 full years.

FINISH COLORS

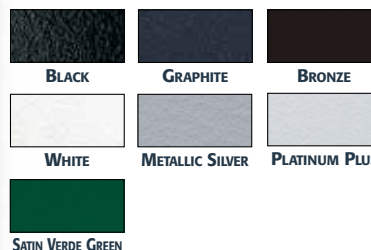

ACCENT STRIPING



QUICK AND EASY INSTALLATION COUPLED WITH ENERGY EFFICIENCY



ELECTRICAL COMPONENTS

Electrical components are factory-mounted in the housing and pre-wired with voltage-specific leads extending out the back of the unit ensuring quick and easy installation. Components are UL listed.



SEALING GROMMET

One-piece grommet, positioned at the point where internal wiring exits the housing, helps keep insects, dust and moisture out of the housing and ballast compartment.

LAMP OPTIONS

Operates with Pulse-Start Metal Halide, Pulse-Start Metal Halide Reduced, Ceramic Metal Halide, Metal Halide, High Pressure Sodium, and Compact Fluorescent lamps. Compact Fluorescent lamps are available in single, double and triple configurations. Lamp supplied as standard—HID (clear, shipped installed), or Compact Fluorescent (coated, 4100K).

HINGED DOOR FRAME WITH FLAT LENS

Simply loosen two captive, stainless steel fasteners for quick and easy access into the fixture. Wire-formed retainer holds door frame in place for ease of maintenance. Compress retainer to remove door frame.

Clear tempered flat glass lens is sealed to the door frame with EPDM gasketing to prevent entry of insects, dust and moisture.

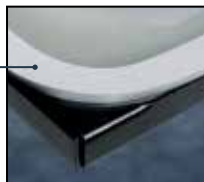

SILICONE GASKET

A one-piece extruded silicone gasket seals the door frame against the housing.

QUICK AND EASY INSTALLATION

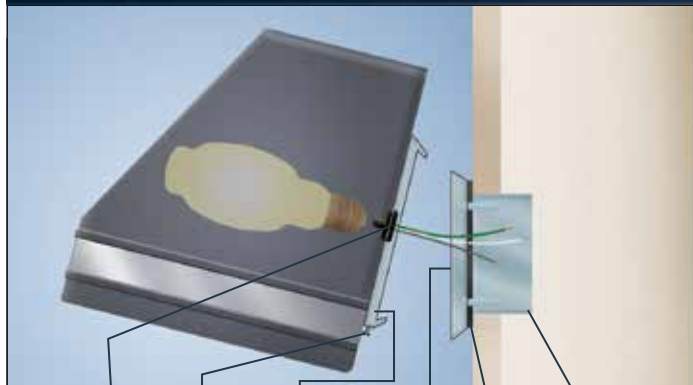

- | | | |
|---------------------|-----------------------|----------------|
| 1 Sealing Grommet | 3 Housing Bracket | 5 Gasket |
| 2 Locking Fasteners | 4 Wall Mounting Plate | 6 Junction Box |

The Greenbriar Wall Sconce comes fully assembled with HID lamp installed. Specially designed mounting plates provide for installation in just three easy steps.

1. Attach gasket and wall mounting plate to junction box.
2. Make wiring connections and attach fixture to wall mounting plate by hanging it over the beveled lip of the wall mounting plate.
3. Lock fixture into place by tightening two hex-head locking fasteners.

REFLECTOR ASSEMBLIES

Reflector models are protected by U.S. Patent # 6,464,378.

Forward Throw (FTM & FT), Type III, and Wall Wash reflectors offer high performance and full cutoff distribution in downlight position as defined by the IESNA. Visit our web site for detailed photometric data, which is tested in accordance with IESNA guidelines.

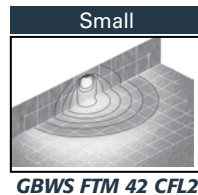

GBWS FTM 42 CFL

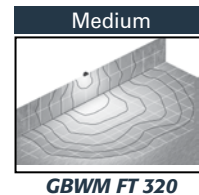

GBWM FT 320 PSMH

THE GREENBRIAR FAMILY –

FOR ADDING A SUBTLE, DECORATIVE TOUCH AND DESIGN CONTINUITY TO YOUR ENTIRE SITE

No matter what your lighting requirements, from the roadway, through the parking lot and along your walkways, the Greenbriar Series offers you the ultimate lighting solution. Choose the best optical package, from select high-brightness LED to high performance HID, to meet your requirements.



LSI INDUSTRIES INC.
10000 Alliance Road
Cincinnati, Ohio 45242
(513)793-3200 FAX (513)793-0147
www.lsi-industries.com

© 2012, LSI INDUSTRIES INC.

9/12 3307