

LED PATRIOT WALL SCONCE (XPWS3)



US patents D562491 & 7828456 and US & Int'l. patents pending

SMARTTEC™ ENERGY SAVING FEATURES:

THERMAL CONTROL - Sensors in both optical unit and driver enclosure reduce drive current when ambient temperatures exceed 50°C. Current is lowered in imperceptible 5% increments every 5 minutes until safe operating temperature is reached.

OCCUPANCY SENSING - Integral sensor (optional) detects movement and activates switching of luminaire to 30% power when no presence is detected. Smart dim slowly lowers light level over a 10-second period.

LEDs - Available with 28 or 48 select high-brightness LED's in Cool White (5300°K nominal) or Neutral White (4200°K nominal) color temperature, 70 CRI (nominal).

DRIVER CURRENT OPTIONS - Choose from two drive current levels; 350mA and 450mA (Drive currents are factory programmed).

OPTICS/DISTRIBUTIONS - Ultra-high efficiency reflectors provide three distributions. Choose from Wide Throw (WT), Forward Throw (FT) or Wall Wash (WW).

OPTICAL UNIT - Clear tempered optical-grade flat glass lens sealed to the die-cast aluminum optic housing creates an IP65 rated unit. Pressure stabilizing breather allows super-tight protection while preventing cycling from building up internal pressures and vacuums that can stress optical unit seals.

DRIVER - Components are fully encased in potting material for IP65 moisture resistance. Driver complies with IEC and FCC standards. Driver can be easily accessed and removed.

ELECTRICAL - Two-stage surge protection (including separate surge protection built into electronic driver) meets IEEE C62.41.2-2002, Scenario 1, Location Category C. Available with universal voltage power supply 120-277VAC (50/60Hz input) and 347-480VAC.

OPTIONAL INTEGRAL MOTION SENSOR - Passive infrared motion sensor activates switching of luminaire light levels. High level light is activated when passersby enter target zone and increased to full bright in 1-2 seconds. Low light level (30% of maximum drive current) is activated when target zone is absent of motion activity for 5 minutes and is gradually ramped down (10 seconds) to low level. Sensor detection range 110° horizontal x 93° vertical x 10 meters maximum distance.

EMERGENCY OPTIONS - Integral emergency battery-back-up options are available. BB option operates in 0°C to 60°C ambient temperature and CWBB operates in -20°C to 60°C ambient temperature. When primary AC power failure occurs, both options operate 10 LEDs for a minimum of 90 minutes. EMR2 option for two external 12 volt circuits for use with 35 watt Halogen lamps (provided) is available.

HOUSING - One-piece die-cast aluminum housing is smoothly contoured rectangular shape. Mounting hardware is stainless steel or electro-zinc plated steel. Housing and optical unit are sealed with extruded silicone gasket; supply conductors with molded EPDM bushing.

OPERATING TEMPERATURE - -40°C to +50°C (-40°F to +122°F).

WALL MOUNTING - Galvanized-steel universal wall mounting plate easily mounts directly to 4" octagonal or square junction box. EPDM gasket is supplied to be installed between mounting plate and junction box, sealing junction box from entrance of water. Universal plate permits fixture to be mounted in uplighting (indoor only) or downlighting position.

POLE MOUNTING - XPMA option adds a clean look closure to the back of the housing and includes bracket to allow fixture to be pole-mounted.

FINISH - Fixtures are finished with LSI's DuraGrip® polyester powder coat finish process. The DuraGrip finish withstands extreme weather changes without cracking and peeling, and is guaranteed for five full years. See ordering guide for available standard colors.

SHIPPING WEIGHT (in carton) - 25 lbs. (11 kg)

EXPECTED LIFE - Minimum 60,000 hours to 100,000 hours depending upon the ambient temperature of the installation location. See LSI website for specific guidance.

WARRANTY - Limited 5-year warranty.

PHOTOMETRICS - Application layouts are available. Contact LSI Applications at lighting.apps@lsi-industries.com

LISTING - ETL listed to ANSI/UL1598, UL8750 and other U.S. and international safety standards. Suitable for wet locations in downlight position. Optional Class 1 Division 2 (groups A, B, C & D) hazardous location rating is available. (Select HL option)

Crossover LED Lighting

lighting facts

A Program of the U.S. DOE

Light Output (Lumens)	4020
Watts	53
Lumens per Watt (Efficacy)	76

Color Accuracy Color Rendering Index (CRI)	67
---	----

Light Color
Correlated Color Temperature (CCT)

5320 (Daylight)

2700K 3000K 4500K 6500K

Warm White Bright White Daylight

All results are according to IESNA LM-79-2008: Approved Method for the Electrical and Photometric Testing of Solid-State Lighting. The U.S. Department of Energy (DOE) verifies product test data and results.

Visit www.lightingfacts.com for the Label Reference Guide.

Registration Number: KGGN-V1H7ZA
Model Number: XPWS3 FT LED 48 350 CW UE
Type: Outdoor wall pack

LIGHT OUTPUT - XPWS3					
Milliamps	# of LEDs	Distribution/Lumens (Nominal)			
Cool White		Type FT	Type WT	Type WW	Watts
350 mA	28	2300	2280	2580	33
	48	4020	3940	4180	53
450 mA	28	2820	2740	3010	44
	48	4810	4680	4970	68
Neutral White					
350 mA	28	2260	2190	2430	32
	48	3740	3570	3760	52
450 mA	28	2660	2600	2850	41
	48	4420	4180	4450	67

This product, or selected versions of this product, meet the standards listed below. Please consult factory for your specific requirements.

IP65

American Innovation
American Made

ARRA Funding Compliant

ROHS COMPLIANT

CE

ETL US Intertek

Suitable for wet locations (downlight only)

Project Name _____

Catalog # _____

LSI Industries
A Company with a Smart Vision

LED PATRIOT WALL SCNCE (XPWS3)

LUMINAIRE ORDERING INFORMATION

TYPICAL ORDER EXAMPLE: **XPWS3 FT LED 48 450 CW UE WHT BB**

Prefix	Distribution	Light Source	# of LEDs	Drive Current	Color Temperature	Input Voltage	Finish	Options
XPWS3 - LED Patriot Wall Sconce	WT - Wide Throw FT - Forward Throw WW - Wall Wash	LED	28 48	350 - 350mA 450 - 450mA	CW - Cool White NW - Neutral White	UE - Universal Voltage (120-277) 347-480	BLK - Black BRZ - Bronze GPT - Graphite MSV - Metallic Silver PLP - Platinum Plus SVG - Satin Verde Green WHT - White	BB - Battery Back-up ¹ CWBB - Cold Weather Battery Back-up ¹ IMS - Integral Motion Sensor EMR2 - Two Emergency 12V Circuit Provisions with (2) 35 Watt Halogen Lamps ² PCI 120 - Button Type Photocell PCI 208 - Button Type Photocell PCI 240 - Button Type Photocell PCI 277 - Button Type Photocell PCI 347 - Button Type Photocell HL - Class1, Division2, Hazardous Location Rating. ETL listed to UL84 ³ XPKMA - Pole Mounting Adaptor w/fixture backplate for use with square poles ⁴ XPKMAR - Pole Mounting Adaptor w/fixture backplate for use with round poles ⁴

ACCESSORY ORDERING INFORMATION (Accessories are field installed)	
Description	Order Number
XPWS3 Polycarbonate Shield	244657
XPWS3 SW BLK - Surface Wiring Box (Available in black only)	356915BLK

FOOTNOTES:

- 1 - Available with UE voltage only.
- 2 - Utilizes GZ4 sockets. 12 volt separate circuits required. Not available with battery back-up, photocell option, HL, XPKMA or XPKMAR options.
- 3 - Not available with battery backup, photocell or EMR2 option.
- 4 - Not available with EMR2 option. Designed with 3" reduced drilling pattern. For S or D180 mounting configuration only.

DIMENSIONS

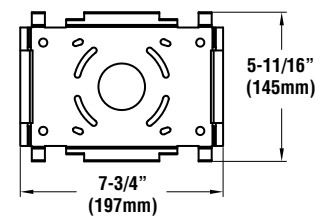
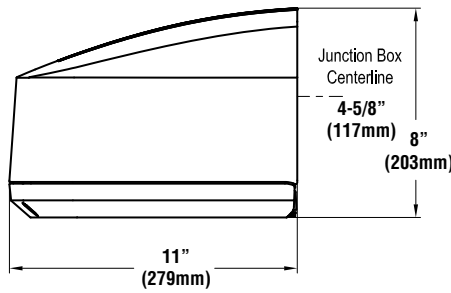
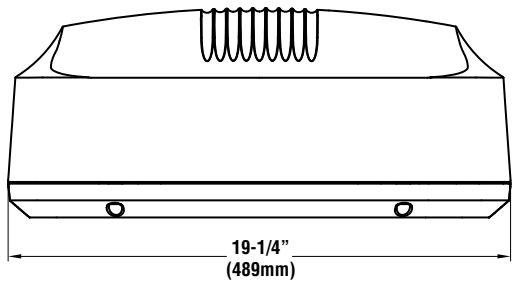

Universal Mounting Plate

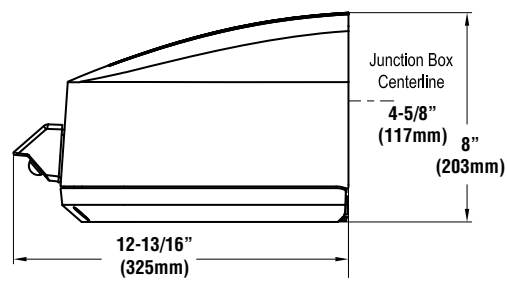
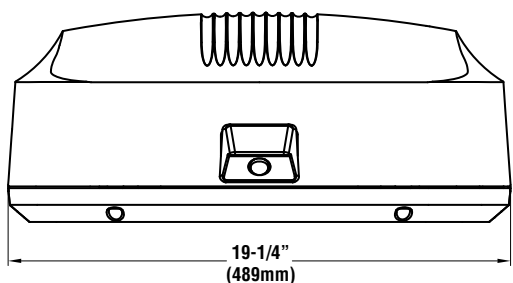

Shown with IMS Option